

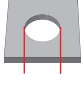
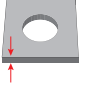
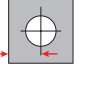

**Malzeme / Material** : CDA-510 Fosforlu Bronz / CDA-510 Phosphor Bronze

Ölçülendirme / Dimensions					Kuvvet / Forces			Ürün / Product	
Çap Diameter		Boy Length ±0.4mm L			Kafa Çapı Head Diameter H ±0.25	Kafa Altı Under Head S Max.	Kafa Kalınlığı Head Thickness T Max.	Önerilen Somun Sıkma Torku Recommended Nut Tightening Torque Nm	
M5X0.8	5.0	15.0	1.3	10.7	7.8	2.7	1.14	2.7	04.HFHBO.M05015
		20.0							04.HFHBO.M05020
		25.0							04.HFHBO.M05025
		30.0							04.HFHBO.M05030
		35.0							04.HFHBO.M05035
		40.0							04.HFHBO.M05040
		50.0							04.HFHBO.M05050

\* Tüm ölçüler mm cinsindedir. / All dimensions are in mm

\* Tüm boy ölçülerinde [+0,1/-0,5] mm tolerans değeri olasıdır. / A tolerance value of [+0,1/-0,5] mm is possible for all length dimensions

\* 1,5 mm veya daha az malzeme kalınlığı için örste bir havşa deliği gereklidir. / For material thickness of 1.5mm or less, a countersunk hole is needed in the anvil.



\* 1,5 mm veya daha fazla malzeme kalınlığı için örste bir geçiş deliği gereklidir. / For material thickness of 1.5mm or more, a through-hole is needed in the anvil

\* Uygulama videosu için QR kodu okutun. / Scan the QR code for the application video.

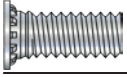
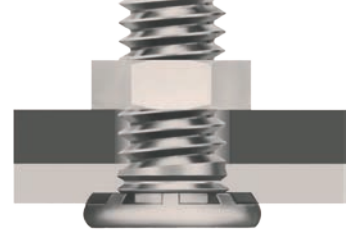
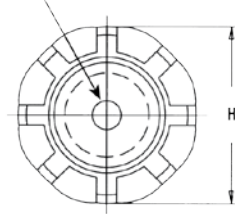
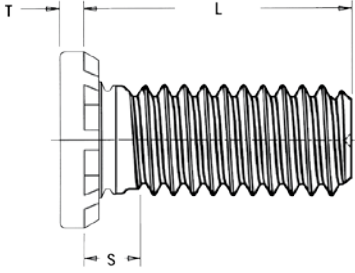

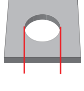
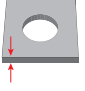
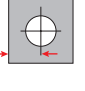

**Malzeme / Material** : CDA-510 Fosforlu Bronz / CDA-510 Phosphor Bronze

Ölçülendirme / Dimensions						Kuvvet / Forces		Ürün / Product	
Çap Diameter		Boy Length ±0.4mm L			Kafa Çapı Head Diameter H ±0.25	Kafa Altı Under Head S Max.	Kafa Kalınlığı Head Thickness T Max.	Önerilen Somun Sıkma Torku Recommended Nut Tightening Torque Nm	
M6X1.0	6.0	15.0	1.5	11.5	9.4	2.8	1.27	4.5	04.HFHBO.M06015
		20.0							04.HFHBO.M06020
		25.0							04.HFHBO.M06025
		30.0							04.HFHBO.M06030
		35.0							04.HFHBO.M06035
		40.0							04.HFHBO.M06040
		50.0							04.HFHBO.M06050

\* Tüm ölçüler mm cinsindedir. / All dimensions are in mm

\* Tüm boy ölçülerinde [+0,1/-0,5] mm tolerans değeri olasıdır. / A tolerance value of [+0,1/-0,5] mm is possible for all length dimensions

\* 1,5 mm veya daha az malzeme kalınlığı için örste bir havşa deliği gereklidir. / For material thickness of 1.5mm or less, a countersunk hole is needed in the anvil.



\* 1,5 mm veya daha fazla malzeme kalınlığı için örste bir geçiş deliği gereklidir. / For material thickness of 1.5mm or more, a through-hole is needed in the anvil

\* Uygulama videosu için QR kodu okutun. / Scan the QR code for the application video.

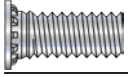
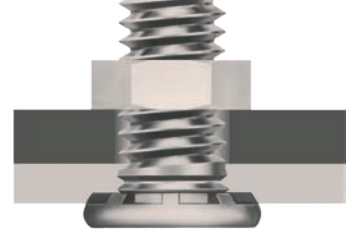
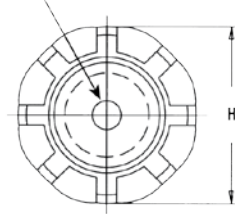
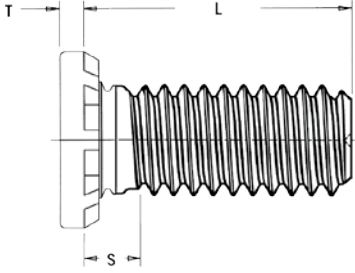

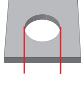
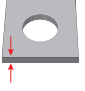
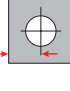

**Malzeme / Material** : CDA-510 Fosforlu Bronz / CDA-510 Phosphor Bronze

Ölçülendirme / Dimensions					Kuvvet / Forces			Ürün / Product	
Çap Diameter		Boy Length ±0.4mm L			Kafa Çapı Head Diameter H ±0.25	Kafa Altı Under Head S Max.	Kafa Kalınlığı Head Thickness T Max.	Önerilen Somun Sıkma Torku Recommended Nut Tightening Torque Nm	
M8X1.25	8.0	15.0	2.0	12.7	12.5	3.5	1.78	11.0	04.HFHBO.M08015
		20.0							04.HFHBO.M08020
		25.0							04.HFHBO.M08025
		30.0							04.HFHBO.M08030
		35.0							04.HFHBO.M08035
		40.0							04.HFHBO.M08040
		50.0							04.HFHBO.M08050

\* Tüm ölçüler mm cinsindedir. / All dimensions are in mm

\* Tüm boy ölçülerinde [+0,1/-0,5] mm tolerans değeri olasıdır. / A tolerance value of [+0,1/-0,5] mm is possible for all length dimensions

\* 1,5 mm veya daha az malzeme kalınlığı için örste bir havşa deliği gereklidir. / For material thickness of 1.5mm or less, a countersunk hole is needed in the anvil.



\* 1,5 mm veya daha fazla malzeme kalınlığı için örste bir geçiş deliği gereklidir. / For material thickness of 1.5mm or more, a through-hole is needed in the anvil

\* Uygulama videosu için QR kodu okutun. / Scan the QR code for the application video.

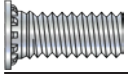
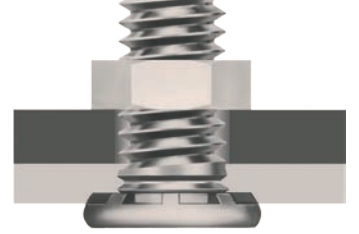
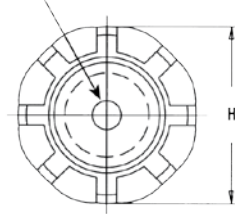
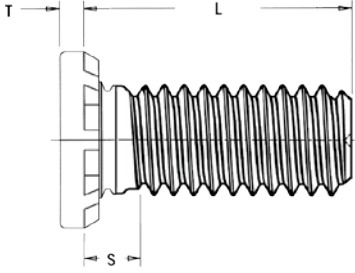

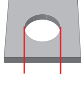
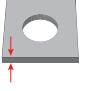
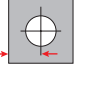

**Malzeme / Material** : CDA-510 Fosforlu Bronz / CDA-510 Phosphor Bronze

Ölçülendirme / Dimensions					Kuvvet / Forces			Ürün / Product	
Çap Diameter		Boy Length ±0.4mm L			Kafa Çapı Head Diameter H ±0.25	Kafa Altı Under Head S Max.	Kafa Kalınlığı Head Thickness T Max.	Önerilen Somun Sıkma Torku Recommended Nut Tightening Torque Nm	
M10X1.5	10.0	15.0	2.3	13.7	15.7	4.1	2.29	31.0	04.HFHB0.M10015
		20.0							04.HFHB0.M10020
		25.0							04.HFHB0.M10025
		30.0							04.HFHB0.M10030
		35.0							04.HFHB0.M10035
		40.0							04.HFHB0.M10040
		50.0							04.HFHB0.M10050

\* Tüm ölçüler mm cinsindedir. / All dimensions are in mm

\* Tüm boy ölçülerinde [+0,1/-0,5] mm tolerans değeri olasıdır. / A tolerance value of [+0,1/-0,5] mm is possible for all length dimensions

\* 1,5 mm veya daha az malzeme kalınlığı için örste bir havşa deliği gereklidir. / For material thickness of 1.5mm or less, a countersunk hole is needed in the anvil.

\* 1,5 mm veya daha fazla malzeme kalınlığı için örste bir geçiş deliği gereklidir. / For material thickness of 1.5mm or more, a through-hole is needed in the anvil

\* Uygulama videosu için QR kodu okutun. / Scan the QR code for the application video.

