

# MEGALOK PERÇİN ST-ST BOMBE KAFA

## MEGALOK RIVET ST-ST DOME HEAD

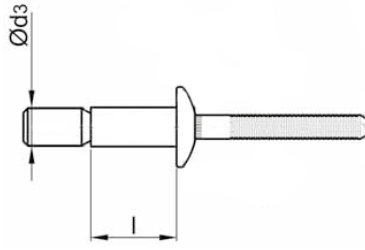

Çelik  
Çinko Kaplama

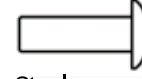





Steel  
Zinc Plated

Çelik  
Çinko Kaplama

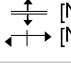
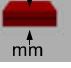

Steel  
Zinc Plated

Ø d3	 [mm]	 [N]	l [+1/-2] [mm]	 mm	ÜRÜN NO PART NO
<b>4,8</b> [+0.01]	Ø 4,9 - 5,1	 [N] 545	10,5	1,6 - 6,9	01.122211.48105
		 [N] 630	14,0	5,4 - 11,1	01.122211.48140
<b>6,4</b> [+0.01]	Ø 6,6 - 6,9	 [N] 1000	14,0	2,0 - 9,5	01.122211.64 140
		 [N] 1250	20,5	8,9 - 15,9	01.122211.64205
			27,0	15,9 - 22,5	01.122211.64270



## MEGALOK PERÇİN AL-AL BOMBE KAFA

### MEGALOK RIVET AL-AL DOME HEAD

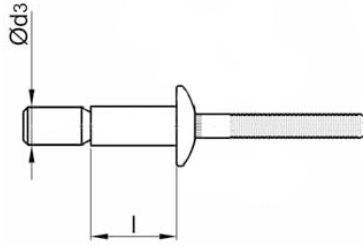

Aluminyum [AlMg2.5]



Aluminyum [AlMg2.5]



Aluminyum [AlMg2.5]

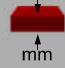
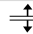
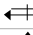
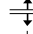

Aluminyum [AlMg2.5]

Ø d3	 [mm]		l [+1/-2] [mm]	 mm	ÜRÜN NO PART NO		
* 4,8	Ø 4,9 - 5,1	 [N] : 430	10,5	1,6 - 6,9	01.121111.48105		
		 [N] : 590	14,5	5,4 - 11,1	01.121111.48145		
6,4	Ø 6,6 - 6,9	 [N] : 910	14,0	2,0 - 9,5	01.121111.64140		
		 [N] : 1150	20,5	8,9 - 15,9	01.121111.64205		



## MEGALOK PERÇİN SS-SS BOMBE KAFA

### MEGALOK RIVET SS-SS DOME HEAD

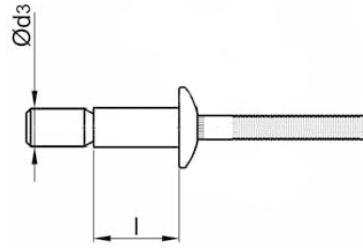

Paslanmaz Çelik  
Parlatılmış

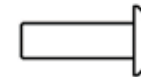

Paslanmaz Çelik  
Parlatılmış



Stainless Steel  
Polished

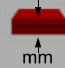
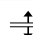
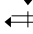
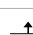

Stainless Steel  
Polished

Ø d3	 [mm]		l [+1/-2] [mm]	 mm	ÜRÜN NO PART NO		
* 4,8 [+0.2]	Ø 4,9 - 5,1	 [N] :	10,5	1,6 - 6,9	01.123311.48105		
		 [N] :	14,5	5,4 - 11,1	01.123311.48145		
6,4 [+0.2]	Ø 6,6 - 6,9	 [N] :	14,0	2,0 - 9,5	01.123311.64140		
		 [N] :	20,5	8,9 - 15,9	01.123311.64205		



# MEGALOK PERÇİN ST-ST HAVŞA KAFA

## MEGALOK RIVET ST-ST COUNTERSUNK HEAD

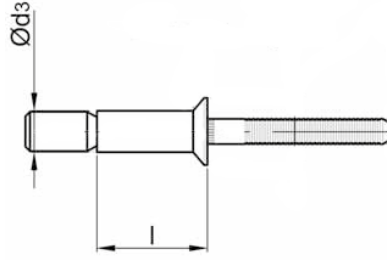

Çelik  
Çinko Kaplama





Steel  
Zinc Plated

Çelik  
Çinko Kaplama



Steel  
Zinc Plated

Ø d3	 [mm]	KUTU BADEİ [mm]	 mm	ÜRÜN NO PART NO	
* 4,8 [+0.1]	Ø 4,9 - 5,1	 [N] :	10,0	3,2 - 8,4	01.122221.48100
		 [N] :	14,0	7,8 - 12,7	01.122221.48140
6,4 [+0.1]	Ø 6,6 - 6,9	 [N] :	16,5	4,1 - 12,0	01.122221.64165
		 [N] :			

